

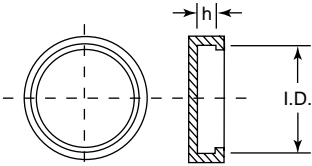

RIVET FEET

FF Series
Fast Foot



Specifications:

- Material: TPR over Acetal
- Color: Black
- Flame Class: UL94 HB

Item No.	Hole Dia.		Panel Thickness		D		H		Bulk Pack Qty
	In	mm	In	mm	In	mm	In	mm	
FF-001B	0.199	5.1	0.039 - 0.091	1.0 - 2.3	0.950	24.0	0.551	14.0	100
FF-003-P3X5.5B	0.124	3.2	0.031 - 0.071	0.8 - 1.8	0.560	14.2	0.217	5.5	100
FF-004B	0.199	5.1	0.039 - 0.091	1.0 - 2.3	0.790	20.0	0.394	10.0	100
FF-005-P4X5B	0.163	4.2	0.039 - 0.091	0.8 - 1.8	0.830	21.0	0.165	4.2	100
FF-005-P4X6B	0.163	4.2	0.071 - 0.111	1.8 - 2.8	0.830	21.0	0.165	4.2	100
FF-005-P4X7B	0.163	4.2	0.114 - 0.146	2.9 - 3.7	0.830	21.0	0.165	4.2	100
FF-005-P4X8B	0.163	4.2	0.150 - 0.189	3.8 - 4.8	0.830	21.0	0.165	4.2	100
FF-006-P4X6B	0.163	4.2	0.024 - 0.039	0.6 - 1.0	0.590	15.0	0.236	6.0	100
FF-006-P4X7B	0.163	4.2	0.039 - 0.079	1.0 - 2.0	0.590	15.0	0.236	6.0	100
FF-006-P4X8B	0.163	4.2	0.079 - 0.118	2.0 - 3.1	0.590	15.0	0.236	6.0	100
FF-006-P5X6.5B	0.203	5.2	0.031 - 0.047	0.8 - 1.2	0.590	15.0	0.236	6.0	100
FF-006-P5X7.5B	0.203	5.2	0.051 - 0.091	1.3 - 2.3	0.590	15.0	0.236	6.0	100
FF-008-P4X6B	0.163	4.2	0.031 - 0.071	0.8 - 1.8	0.830	21.0	0.236	6.0	100
FF-008-P4X7B	0.163	4.2	0.075 - 0.110	1.9 - 2.8	0.830	21.0	0.236	6.0	100
FF-008-P4X8B	0.163	4.2	0.114 - 0.157	2.9 - 4.0	0.830	21.0	0.236	6.0	100
FF-009-P4X6B	0.163	4.2	0.000 - 0.031	0.0 - 0.8	0.830	21.0	0.315	8.0	100
FF-009-P4X7B	0.163	4.2	0.031 - 0.079	0.8 - 2.0	0.830	21.0	0.315	8.0	100
FF-009-P4X8B	0.163	4.2	0.083 - 0.118	2.1 - 3.0	0.830	21.0	0.315	8.0	100
FF-010-P4X7B	0.163	4.2	0.039 - 0.079	1.0 - 2.0	0.590	15.0	0.354	9.0	100
FF-010-P4X8B	0.163	4.2	0.079 - 0.118	2.0 - 3.1	0.590	15.0	0.354	9.0	100
FF-13-P3.5X4.5B	0.144	3.7	0.020 - 0.047	0.5 - 1.2	0.430	10.8	0.157	4.0	100
FF-13-P3.5X5.5B	0.144	3.7	0.047 - 0.079	1.2 - 2.0	0.430	10.8	0.157	4.0	100
FF-13-P3.5X6.0B	0.144	3.7	0.059 - 0.087	1.5 - 2.2	0.430	10.8	0.157	4.0	100
FF-13-P3.5X7.0B	0.144	3.7	0.098 - 0.126	2.5 - 3.2	0.430	10.8	0.157	4.0	100

SFF
Soft Fast Foot

- Rivet is pushed in, locking foot in place
- Prevents surface damage with anti-skid and scratch resistant properties
- Made of abrasion resistant rubber to help cushion and provide vibration control
- High shear strength
- Material: Foot: UL94 HB TPE, 86 Shore A
- Pin: Polypropylene
- Color: Black

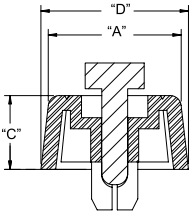

Item No.	Hole Ø	Panel Thickness	"A" Ref.	"C" Ref.	"D" Ref.	Bulk Pack Qty
SFF-018	.305 (7.75)	.031 - .059 (0.8 - 1.5)	.71 (18)	.39 (10)	.79 (20)	100
SFF-021	.305 (7.75)	.197 - .315 (5.0 - 8.0)	.79 (20)	.24 (6)	.83 (21)	100
SFF-023	.305 (7.75)	.031 - .059 (0.8 - 1.5)	.91 (23)	.20 (5)	.98 (25)	100
SFF-028	.305 (7.75)	.031 - .059 (0.8 - 1.5)	.71 (18)	.59 (15)	.79 (20)	100

FSR Series
Snap Rivet Mount Foot



Specifications:

- Material: TPE over Nylon 6
- Color: Black
- Flame Class: UL94V-2

Item No.	Hole Diameter		Panel Thickness		D		H		C		Bulk Pack Qty
	In	mm	In	mm	In	mm	In	mm	In	mm	
FSR-1	0.144	3.7	0.047 - 0.083	1.2 - 2.1	0.394	10.0	0.189	4.8	0.138	3.5	1000
FSR-2	0.144	3.7	0.083 - 0.118	2.1 - 3.0	0.394	10.0	0.189	4.8	0.177	4.5	1000
FSR-3	0.163	4.1	0.098 - 0.138	2.5 - 3.5	0.394	10.0	0.189	4.8	0.197	5.0	1000
FSR-4	0.144	3.7	0.047 - 0.083	1.2 - 2.1	0.500	12.7	0.138	3.5	0.138	3.5	1000
FSR-5	0.144	3.7	0.083 - 0.118	2.1 - 3.0	0.500	12.7	0.138	3.5	0.177	4.5	1000
FSR-6	0.163	4.1	0.098 - 0.138	2.5 - 3.5	0.500	12.7	0.138	3.5	0.197	5.0	1000

